



# GUMMOON INDUSTRY COMPANY PROFILE



# Company Overview

## History of Gummoon

1996. 04	Established as GUMMOON Industries Co., Ltd.
1999. 07	Registered as the Tier 1 Vendor for Hyundai Motor Group
2003. 03	Business Research Institute established
2005. 02	Obtain TS 16949, ISO-14001 Certificates
2007. 01	Registered as the tier 1 Vendor for General Motors
2008.12	Sales office established in the U.S.(Detroit, AL)
2010.01	Started Sales in the North America Region (YF SONATA(HMC)[Black Trivalent Cr3])
2011.11	Plant 2 approved under GM GLOBAL CQI-11
2012.11	Injection Molding Plant established
2013.03	Established a Plant(Assembly Line) at the U.S Branch Office(Gummoon USA)
2013.05	Designated as Root Technology Specialized Business(First ever as a Plating Enterprise)
2015.11	Established LINE 3 for Plating
2016.07	Plating Line 3 approved under GM GLOBAL CQI-11
2016.10	Registered as the tier 1 Vendor for Volkswagen, Ford, DTNA
2017.01	Registered as the tier 1 Vendor for SKODA (Affiliate of Volkswagen(Europe))
2018.11	Obtain GM1927-30 BIQS(LV.3)
2019.06	Build a Smart Plant(ERP System)
2019.12	Established the Robot Painting line (10 shuttles)
2020.12	Awarded GM SQEA two consecutive years (2019~2020)

## Overview

Founded	1996. 04
CEO	Moon Sik Kim
Products	<ul style="list-style-type: none"> <li>• Radiator Grille</li> <li>• Emblem/Lettering</li> <li>• Bumper/Fog Lamp Molding</li> <li>• Garnish</li> </ul>
Employees	<ul style="list-style-type: none"> <li>• 151 Current at 2021</li> <li>- Research/Design Engineers : 16</li> <li>- Development PM/QC Engineers : 19</li> </ul>
Key Facility	<ul style="list-style-type: none"> <li>• Research/Design/Injection Molding /Plating Line1,2,3/ Pilot Line (Prototype Production Development)/ Full Automated Robot Painting Line(10 shuttles)</li> </ul>

### [Sales By Year]

(Unit : 1M,USD/Exchange rate : 1,100 USDKRW)

	Y2019	Y2020	Y2021		
			Jan-Mar (Records)	Apr-Dec (Expected)	Year (Expected)
Sales	81.3	65.4	20.2	66.9	87.1

### [Certificate of Registration]

NO	Certificate of Registration	Certification Date	Expiration Date
1	IATF16949:2016	2021.04	2024.04
2	ISO14001:2015	2020.02	2023.02
3	KS I ISO14001:2015	2020.02	2023.02
4	KS Q ISO 45001:2018	2019.11	2022.11
5	ISO 45001:2018	2019.11	2022.11



general motors  
**Supplier Quality Excellence Award**  
**2020**

Presented to:  
**GUMMOON INDUSTRY CO LTD**

**688452309**

For your outstanding 2020 performance to  
**General Motors.**

*Thank You*

*Rick Demuynck*

Rick Demuynck  
Executive Director Supplier Quality & Development  
01/01/2021

*Jewel Shi*

Jewel Shi  
Director GM International Operations  
01/01/2021



GENERAL MOTORS

# Supplier Quality Excellence Award 2019

Presented to:  
**GUMMOON INDUSTRY CO LTD**

**688452309**

For your outstanding 2019 performance to  
General Motors.

*Thank You*

*Rick Demuynck*

Rick Demuynck

Executive Director Supplier Quality & Development

01/01/2020

*Jewel Shi*

Jewel Shi

Director GM International Operations

01/01/2020



GENERAL MOTORS

※SQEA 2020 Award-winning confirmed (Awarded for 2 Consecutive Years)

## 1. Head Office

	PLANT 1(HQ)	PLANT 2	PLANT 3
Established	2000.08	2011.01	2012.12
Production Process	Plating / Painting / Assembly	Plating Line	Injection Molding
Key Facility	Plating Line 1 Plating Line 3 Robot Painting Line Painting Line Assembly/Packaging Line	Plating Line 2	Small-sized(100~220 ton) : 14 units Large-sized(315~2,000 ton) : 31 units
Land Size(sqft)	172,883	32,171	57,651
Address	-Noksan Industry Jungro 224(Songjung-Dong), Gangse-Gu, Busan, Republic of Korea -Contact info : +82+51-831-0151	-8, Noksansandan 261-ro 23beon-gil, Gangseo-gu, Busan, Republic of Korea	-50, Gwahaksandan-ro 333beon-gil, Gangseo-gu, Busan, Republic of Korea

## 2. Branch Office

	Gummoon USA LLC	Gummoon Europe s.r.o.
Location	North America	Czech Republic
Founded	2013.03	2014.02
Information	<ul style="list-style-type: none"> <li>- Operating an warehouse and assembly lines</li> <li>- R&amp;D engineers</li> <li>- Sales Business R.E.P</li> <li>- Serving local customers in North America, Canada, Mexico and Brazil</li> </ul>	<ul style="list-style-type: none"> <li>- Operating an warehouse, serving local customers</li> <li>- Sales operation for automakers in the Czech Republic, the Slovak Republic, Germany and Hungary</li> </ul>
Address	-2292 Pumphrey Ave, Auburn AL 36830 -Contact Info Office : +1-334-502-8899 -Contact Info Direct : +1-214-881-8042 <a href="mailto:john.cho@gummoonusa.com">john.cho@gummoonusa.com</a>	-U Rourovny 556/3, Svinov, 721 00 Ostrava, Czech Republic -Contact Info: +420-725-977-359 <a href="mailto:hong@gummooncz.com">hong@gummooncz.com</a>

Radiator Grille, Emblem, Molding(plating/painting molding product for decoration)  
Fog(Fog cover)



Radiator Grille



Emblem



Fog Lamp  
Molding Cover



Tail Gate Garnish



Bumper Molding



Wheel Cover Cap/Hub





# Main Product : Products Manufactured with Gummoon Components



PALISADE(LX2)



TUCSON(NX4)



SORENTO(MQ4)



ELANTRA(CN7)



K8(GL3)



IONIQ5(NE)

# Main Product : Products Manufactured with Gummoon Components



**CAMARO CONV  
(A1AC)**



**TRAX(G1UC)**



**MALIBU(E2SC)**



**SPIN(G1NC)**



**BLAZER(C1UC)**



**ENCORE(G1UB)**

# Sales share by Products

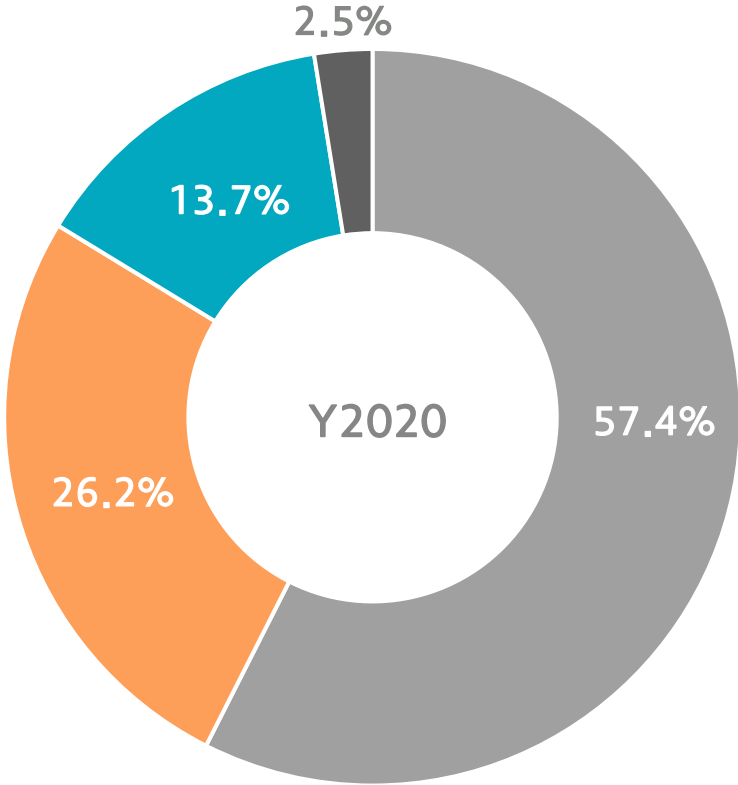
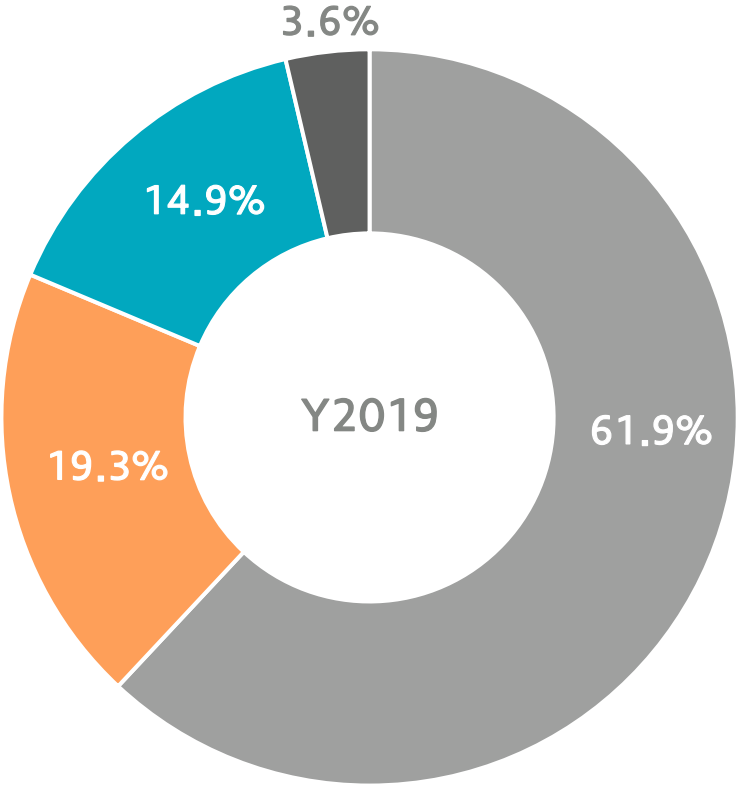

■ R/GRILLE ■ MOLD'G ■ EMBLEM ■ OTHERS

■ R/GRILLE ■ MOLD'G ■ EMBLEM ■ OTHERS



## MES System in place

### 1. DESIGN AND DEVELOPMENT

#### ✚ PRODUCT DESIGN PROCESS

- Prevention of failure through DFMEA
- Standardization and utilization of common design
- Product design considering plating characteristics
- Sensitive engineering design for better design quality
- Structural design for better endurance quality

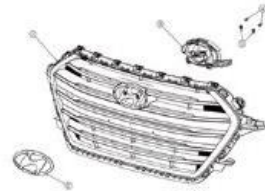

#### ✚ DEVELOPMENT (PRODUCTS/MOLDS) PROCESS

- Quick response from design review to mass production
- Early review on establishment of FMEA and 4M system for mold development
- Quick response for customers and optimized development of products/molds through standardized systems for design, QC and manufacturing

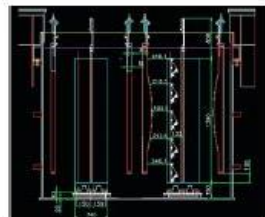

### 2. INJECTION MOLDING PROCESS

#### ✚ INJECTION MOLDING PROCESS

- Specialized technology considering characteristics of plating/painting
- Digitalization of track records and performance data through POP SYSTEM
- Utilization of injection molding machines of various capacity  
→ producing injection molded products of various shapes and types

#### [Injection Molding Capacity]

Size	Units	Note
Small-sized	14	100 ~ 220 ton
Mid-sized	24	450 ~ 850 ton
Large-sized	7	1,050 ~ 2,000 ton
<b>Total</b>	<b>45</b>	





## MES System in place

### 3. PLATING PROCESS

#### ✂ PLATING PROCESS

- Improved corrosion resistance through micro-porous technology
- Application of various techniques per plating line (Satin, White trivalent Cr, Black trivalent Cr, Hexavalent Cr)
- Automation manufacturing line established
- Digitalization of track records and performance data through POP SYSTEM
- PILOT LINE at each plant → plating quality stabilization
- Capable of designing/manufacturing racks → plating quality improvement

#### [Plating Line Capacity]

	Line 1	Line 2	Line 3
Capacity (/Month)	3,750,000(dm <sup>2</sup> )	7,500,000(dm <sup>2</sup> )	13,750,000(dm <sup>2</sup> )
Finish Color <small>*1dm<sup>2</sup> = 10cm × 10cm</small>	White Trivalent Cr Black Trivalent Cr Satin, Hexavalent Cr	Hexavalent Cr	White Trivalent Cr Black Trivalent Cr Satin, Hexavalent Cr

### 4. PAINTING PROCESS

#### ✂ PAINTING PROCESS

- Automation line established for glossy(body color) and matte(masking) painting

#### [Painting Line Capacity]

Painting Line	Capacity(/Month)	Finish Color
Robot Painting Line	10,300,000(dm <sup>2</sup> )	Paint on Chrome(Tinted) / Color / Masking

\*1dm<sup>2</sup> = 10cm × 10cm

### 5. ASSEMBLY PROCESS

#### ✂ ASSEMBLY/PACKAGING PROCESS

- CELL manufacturing lines established for multi-product production
- Strict product shipping inspection system at various stages by operators and inspectors
- ANDON System to detect and take actions against defective parts
- Digitalization of track records and performance data through POP SYSTEM

## Highest Mass Production in House Design of Radiator Grille in History in Korea

- Great Relationship between Tiers built Trust to Growth
- In House Design Capability & Tool Build Capability : Radiator Grille Design Top-Tier Level (10 Vehicle/year Avg)
- Radiator Grille, Bumper Molding, Lamp ETC : Counter Component Design Capability to Ensure of Fitment/Function
- Faster Counter Action due to in House Design/Molding/Painting/Plating Capability

## Modular Component Strategy

- Acquired Business Venture Relationship with Automotive Lighting Company Targeting LED, PCB/FPCB to Accommodate Trend of Automobile World
- Acquired Tooling Development of lenses based PC
- Acquired of Expert Engineer in Variety Surface Finishes & Injection Molding to Create a Harmony Process of Production
- Designated TFT will be established to specifically Target Lighting Radiator Grille/Front End Facia by Third Quarter of 2021

## Development & Competitive Mass Production Capability

- Able to Produce High in Volume of Mass Production due to Proprietary Technology
- Total # of Injection Molding of 45 (100 ton~ 2,000 ton)
- 3 Lines of Plating
- Fully Automated Paint Robot/Convey/Shuttle Capability
- Automated Cell Type Assembly Line

## Starting Smart Factory (Design-Final Product) Automation

- One Stop Process Design till Final Product with Automation
- In House Pilot Line for Trials before Mass Production to Ensuring Quality of the Component
- IN House 3D Printing Capability
- Full Line of Testing Equipment in House
- MES System Operation of Smart Factory to Ensuring Quality Process Components with Accumulated Data to Prevent Failure in House/OEM/Final Consumer

# High Technical Perfection and Design Ability of Global Top-Tier Product

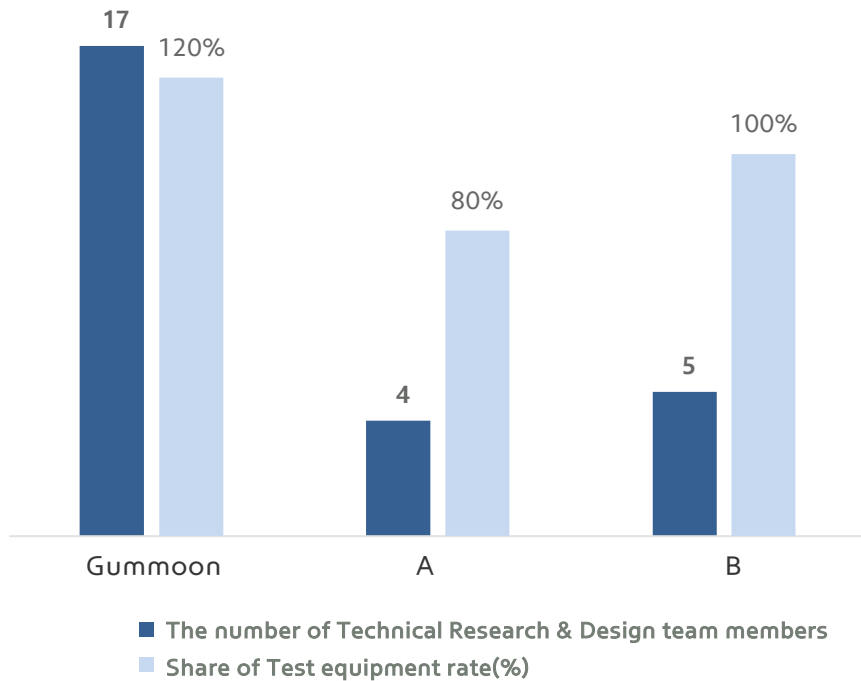

- Collaboration for New Technology Product with Customer
- Investment in R&D and Design has High Development Capacity
- Test Equipment Retention Rate is 120% Approved by OEM
- Leader of Trivalent Chrome Plating, HOTSTAMPING, etc. (First Mass Production Implemented of New Surface Finish Technology)



- Global Top Tier Level of Design in Rad Grille (10 Vehicles Per Year on Average)
- Excellent Design Capabilities & Reinforcement of Electrical/Electronic to Accommodate Future Technology
- Pre-Production of Trial Product with 3D Printer
- Analyze Failure Factors of Process and Design to Ensure the Quality of Mass Production

# Securement of Global Customer: Top 10% Suppliers in Korea





# **Growth Strategies**

# Development Roadmap



32라인 생산현황	
목표수량	2500
실적수량	2250
달성율	90%
AA Line RUN 8회 생	

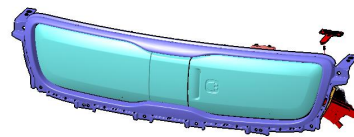

Investment

Stabilization of Production/Operation and Smart Plant Improvement

Expansion of Eco-Friendly Car Parts and Expanding Electrical Device Collaboration on Exterior Components

Global Expansion

	Level	Standard	Focus	Key Factor	Condition
<b>Top</b>	Level5	Self Drive	Workers, Equipment, Materials, Operating Condition+ Environment	Customization +Automation	Full Self-Automation
<b>Mid2</b>	Level4	Optimized	Workers, Equipment, Materials, Operating Condition	Optimized	Prevention Control Capability Through Process Simulation
<b>Mid1</b>	Level3	Control	Workers, Equipment, Materials	Analyzed	Operation Full Control based on Collected Data
<b>Entry 2</b>	Level2	Monitoring	Workers, Equipment, Materials	Assessment	Real Time Monitoring Full Production
<b>Entry</b>	Level1	Inspect	Materials	Identify	Partially Standardizing+ Managing data

2023~2024: Lv5 Build



2021~2022: Lv4 Build



# Expansion of Eco-Friendly Car Parts and Electrical Components

Gummoon Product is Applied in Customer's Demand of Eco-Friendly Car Line  
Collaboration of Product Improvement as Expansion of Eco-Friendly Car

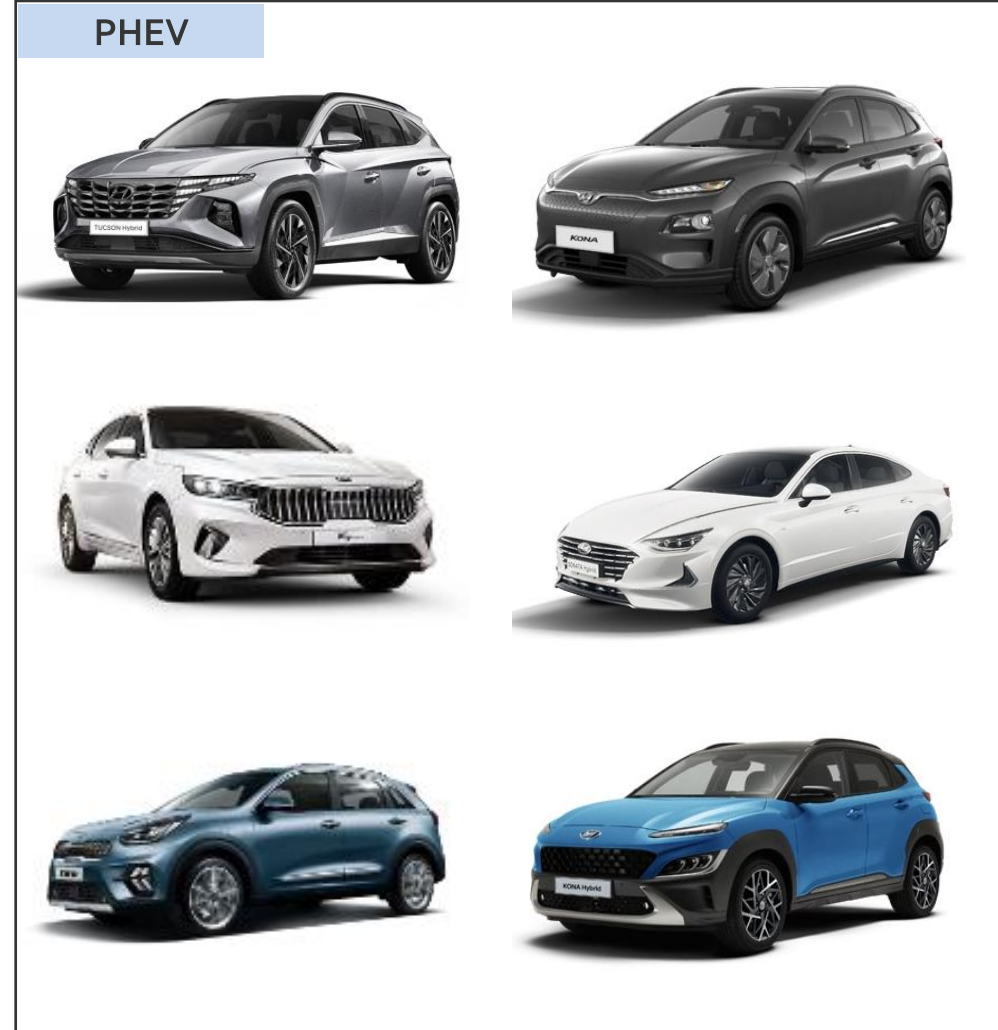

Gummoon's Exclusive  
Design for Electric  
Vehicles Radiator Grille



## Following the Trend of Surface Treatment Variation therefore Strengthening of Grille Functionality

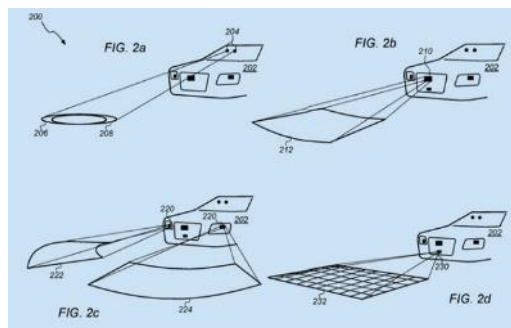

<Example of Front Grille Design>

### ► Communication Lighting Radiator Grille Front-end Electronics Module Development(2020 ~ )

- Gummoon is investing in New LED Radiator Grille as the Trend of Automotive Direction
- Gummoon is investing in Front Facia as Global Trend is Focused on EV
- Advantage
  - ① Communication between Vehicle and Pedestrian  
: Sense the Pedestrians, Sending Warning Audible/Visual Light to Protect both Pedestrians and Vehicle(Driver)
  - ② Warning Fiction of lamp during Braking
  - ③ Change of Color Mode of Driving(Self-Drive: Blue, Driver Drive: Green )
  - ④ Visual Signal Indicator During Left Turn or Right Turn
  - ⑤ Design Enhancement



Following the Trend of Surface Treatment Variation therefore Strengthening of Grille Functionality



AUDI (EV)

▶ Started EV Radiator Grille Development (2019~)

- Mechanism module operated for EV charger door open and shut is added including motor, actuator, etc., in order to Achieve a Full Functioning Radiator Grille Design
- As well as Charger Module, Design/Function of Lamp-Bumper-Radiator Grille is Developed. So as high Demand Design Ability is needed to Role of Sensor Housing for Automatic Driving and Lamp/DRL.

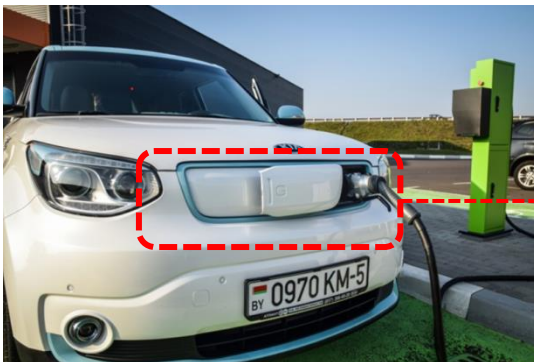

KIA SOUL (EV)

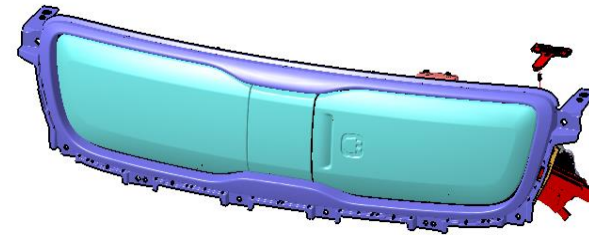

◀ Grille Front Mechanism Module Component

## Expansion of Business with Existing Customer with EV OEM

### Existing Customer

### Future Customer

#### OEM Company



#### Tier Company



#### EV OEM

